

Control of Pollution Act 1974  
Part I

WASTE DISPOSAL LICENCE

THE CAMBRIDGESHIRE COUNTY COUNCIL HEREBY GRANTS a Waste Disposal Licence, pursuant to an application dated 21/02/94 to:

Mick George (Haulage) Ltd  
Second Drove  
Meadow Lane  
St. Ives  
Huntingdon  
Cambridgeshire

authorising the disposal of waste by means of a Transfer Station on land at:

Second Drove  
Meadow Lane  
St. Ives  
Huntingdon  
Cambridgeshire

National Grid Reference: TL 323707

The Licence is granted subject to the conditions set out hereafter:-

Signed



Dated: 2nd August 1994

Designation Waste Regulation Officer

**General Note: Appeals**

If a licence holder is aggrieved by the decision of the Waste Disposal Authority in granting a Licence subject to conditions he may appeal to the Secretary of State in accordance with section 10 of the Control of Pollution Act 1974. Appeals must be notified within six months of the date of this notice to The Planning Inspectorate, Room 10/13, Tollgate House, Houlton Street, Bristol, BS2 9DJ. The Secretary of State has power to allow a longer period for the giving of notice of an appeal but will not normally be prepared to exercise this power unless there are special circumstances which excuse the delay in giving notice of an appeal.

NB - The issue of this licence under the provisions of Part I of the Control of Pollution Act 1974 in no way lessens the need of the licence holder to comply with other legislation and any statutory obligations which rest on him thereunder, in particular the Health and Safety at Work, etc Act 1974, The Radioactive Substances Act 1960, and any legislation relating to planning, water protection and environmental health.

<b>CONTENTS</b>
-----------------

- 1. GENERAL**
    - 1.1 Licensed area
    - 1.2 Acceptable wastes
  - 2. ADMINISTRATION**
    - 2.1 Commencement of operations
    - 2.2 Cessation of operations
    - 2.3 Responsible persons
    - 2.4 Incident reporting
    - 2.5 Waste records
    - 2.6 Waste returns
  - 3. SITE FACILITIES AND INFRASTRUCTURE**
    - 3.1 Site identification board
    - 3.2 Site office
    - 3.3 Site security
    - 3.4 Fuel storage
    - 3.5 Vehicle movement areas
  - 4. OPERATIONS: GENERAL**
    - 4.1 Manning
    - 4.2 Hours of operation
    - 4.3 Lighting
    - 4.4 Fire
  - 5. WASTE ACCEPTANCE**
    - 5.1 Waste inspection and acceptance
    - 5.2 Unacceptable waste
    - 5.3 Non-reclaimable material
  - 6. SPILLAGE**
    - 6.1 Absorbent material provision
    - 6.2 Spillage clearance
  - 7. WASTE HANDLING AND TRANSFER**
    - 7.1 Equipment
  - 8. WASTE STORAGE**
    - 8.1 Storage height limit
  - 9. ENVIRONMENTAL CONTROL**
    - 9.1 Litter control
    - 9.2 Litter control failure
    - 9.3 Dust control
    - 9.4 Pest control
- APPENDIX A Definitions  
Interpretation  
Address for correspondence
- APPENDIX B Permitted waste types
- SCHEDULE 1 Quarterly Waste Return Form

<b>GENERAL</b>
----------------

- 1.1 LICENSED AREA** This licence relates only to land outlined in red on drawing number ASC/92/9/S1 attached.
- 1.2 ACCEPTABLE WASTES** Wastes handled shall be restricted to the types listed in category 1 of Appendix B attached.

Waste may only be received at the site for the purpose of recycling. No more than 5, 000 tonnes of such waste may be received at the site for keeping or treatment in any year (from 1st April to 31st March).

<b>ADMINISTRATION</b>
-----------------------

- 2.1 COMMENCEMENT OF OPERATIONS** At least 14, but not more than 30, days notice shall be given in writing to this Authority before waste disposal commences.
- 2.2 CESSATION OF OPERATIONS** At least 14 days notice shall be given to this Authority of:
- a) any proposal to cease normal operations for more than one month;
  - b) re - starting normal operations after 2.2a) above.
- 2.3 RESPONSIBLE PERSONS** Waste shall not be accepted for disposal until the licence holder has notified this Authority in writing of a 24 hour emergency telephone number and the name, business address and telephone number of:
- a) the person(s) responsible for accepting or rejecting waste on site;
  - b) the person(s) responsible for day-to-day control of operations on site.

Any change to the information given under this condition shall be notified immediately to this Authority.

- 2.4 INCIDENT REPORTING** This Authority shall be informed as soon as practicable of any incidents that do, or could, give rise to danger to public health, pollution of water or detriment to the local amenities.
- 2.5 WASTE RECORDS** Records shall be kept of waste deposited at, and removed from, the site. These records shall be sufficient to provide the information required by condition 2.6.
- 2.6 WASTE RETURNS** Quarterly waste handling returns, providing the information required in schedule 1 attached, shall be furnished to this Authority, for each period:
- a) 1st April - 30th June;
  - b) 1st July - 30th September;
  - c) 1st October - 31st December; and
  - d) 1st January - 31st March,

within 14 days of the end of the relevant period.

<b>SITE FACILITIES AND INFRASTRUCTURE</b>
---

**3.1 IDENTIFICATION BOARD** A site identification board shall be displayed at the site entrance clearly showing:

- a) name of the site;
- b) normal hours of opening;
- c) name, address and telephone number of:
  - i) the disposal licence holder (and site operator if different) including a 24 hour emergency number; and
  - ii) this Authority.

*NOTE: The name and telephone number of this Authority is as follows:  
Cambridgeshire County Council  
Waste Regulation Authority  
Tel. (0480) 432224*

**3.2 SITE OFFICE** There shall be a control office on site with the following provided and maintained:

- a) a working telephone;
- b) a current copy of this licence.

**3.3 SITE SECURITY** Gates and fencing shall be provided and maintained so as to prevent unauthorised access to the site. The gates shall be kept locked shut at all times the site is unsupervised.

**3.4 FUEL STORAGE** Fuel storage tanks shall be bunded so as to intercept spillage. The bund shall be impervious and have a capacity not less than 110% of the tank it surrounds. The bunded area shall be emptied as necessary so as to maintain an available capacity greater than 105% of the tank that it surrounds and a means of identifying this minimum available capacity shall be provided. There shall be no bund drainage outlets.

**3.5 VEHICLE MOVEMENT AREAS** Vehicle movement areas and associated drainage shall be provided and maintained so as to ensure that:

- a) material is not carried onto the public highway on the wheels of vehicles;
- b) standing surface water bodies do not develop; and
- c) there is no pollution of the environment.

*NOTE: Drainage discharge to:*

- i) surface waters will require the permission of the National Rivers Authority; or
- ii) sewer will require permission of Anglian Water Services.

*This Authority will require proof of such permission.*

<b>OPERATIONS: GENERAL</b>
----------------------------

**4.1 MANNING** Activities under this licence shall only take place in the presence of a sufficient number of appropriately trained supervisory and/or operating staff to ensure that the relevant conditions are complied with.

**4.2 HOURS OF OPERATION** Waste shall only be accepted at the site during the following hours:

- i) Monday to Friday 0700 - 1800 hrs
- ii) Saturday 0700 - 1300 hrs

There shall be no waste handling operations on Bank or Public (England) Holidays.

- 4.3 **LIGHTING** Condition 4.2 notwithstanding, no activities relating to waste disposal shall take place during the hours of darkness unless adequate lighting is provided and in use.
- 4.4 **FIRE** No materials shall be burned within the boundaries of the site. A fire at the site shall be treated as an emergency and immediate action taken to extinguish it. Outbreaks of fire shall be reported forthwith to this Authority.

### WASTE ACCEPTANCE

- 5.1 **WASTE INSPECTION AND ACCEPTANCE** All wastes delivered to the site shall be inspected on arrival for suitability regarding waste type and quantity.

Small quantities of non-hazardous solid waste, delivered mixed with permitted waste, may be accepted. Such waste must be immediately sorted and dealt with according to condition 5.3.

5.2 **UNACCEPTABLE WASTE**

- a) the vehicle delivering the waste shall not be permitted to leave the site until the acceptability of the full load has been confirmed;
- b) any waste that is found to be unacceptable, or the acceptability of which cannot be assessed, shall there and then be loaded back onto the waste delivery vehicle;
- c) should b) above be impractical this Authority shall be contacted immediately and no further action shall be taken (except for immediate safety reasons) except as it directs.

- 5.3 **NON RECLAIMABLE MATERIAL** Any waste entering or being generated on site, which is destined for final disposal instead of reclamation, shall be immediately placed in a suitable container or skip provided on site.

### SPILLAGE

- 6.1 **ABSORBENT MATERIAL PROVISION** Dry absorbent materials, such as sand or sawdust, shall be maintained on site.

- 6.2 **SPILLAGE CLEARANCE** Spillages shall be immediately cleared up and dealt with, in the case of liquids using appropriate absorbent material provided under condition 6.1, so as to alleviate the effect of the spillage, to prevent water pollution and to ensure safety. The resulting contaminated material shall be immediately removed and placed in the container provided under condition 5.3.

### WASTE HANDLING AND TRANSFER

- 7.1 **EQUIPMENT** A suitable vehicle shall be provided, maintained and used on site for waste handling and transfer operations. Should the machine, for any reason, become unserviceable, its repair or arrangements for replacement must be put in hand immediately.

If there is reason to believe that no serviceable machine will be available at the site for either:

- a) more than three hours; or
- b) the rest of the working day;

whichever is shorter, then no more waste shall be unloaded at the site until either the initial machine is repaired or a serviceable replacement arrives.

**WASTE STORAGE**

- 8.1 STORAGE HEIGHT LIMIT** No waste shall be stored to a height exceeding 6 metres and a marker shall be provided and maintained to indicate this height.

**ENVIRONMENTAL CONTROL**

- 9.1 LITTER CONTROL** Screening shall be provided, and used as necessary to prevent windblown material leaving the licensed area.
- 9.2 LITTER CONTROL FAILURE** Condition 9.1 notwithstanding, should wind blown material leave the licensed area, the site shall stop accepting waste until this can be prevented.
- 9.3 DUST CONTROL** In dry weather site roads, and any other area used by vehicles, shall be sprayed with water as required to prevent airborne dust.
- 9.4 PEST CONTROL** Precautions shall be taken to prevent, and sufficient action taken to terminate, breeding and harbouring of insects and vermin on the site.

APPENDIX A
------------

For the purposes of this licence the following apply.

### DEFINITIONS

Where the following words and expressions are used in the conditions of this licence they shall have the meanings hereby assigned to them except where the context otherwise requires.

- a) *"accepted for disposal"* means waste which is left in the control of the disposal site operator.
- b) *"approval"* means approval in writing by this Authority
- c) *"Authority, the"* means Cambridgeshire County Council Waste Regulation Authority
- d) *"maintain"* means kept in a fit state, including such regular inspection, servicing and repair as may be necessary, to adequately perform its function
- e) *"month"* means calendar month
- f) *"site"* means those areas herein licensed under condition 1.1
- g) *"working day"* means those times in any day during which waste handling operations are permitted.

### INTERPRETATION

- a) Words in the singular include the plural and words in the plural include the singular.
- b) The headings and notes in the conditions of this licence shall not be deemed to be part thereof or to be taken into consideration in the interpretation or construction thereof or of the licence.
- c) Insofar as the working plan may conflict or be inconsistent with the conditions attaching to this licence, the conditions shall prevail.
- d) All references herein to conditions are references to conditions of this licence.

### ADDRESS FOR CORRESPONDENCE

Any document herein required of the licensee is to be submitted in writing to:

Cambridgeshire County Council  
 Waste Regulation Authority  
 Stanton House  
 Stanton Way  
 Huntingdon  
 Cambs  
 PE18 6XL

Telephone number (working hours)	(0480) 432224
Facsimile transmission number	(0480) 457041

APPENDIX B: WASTE CATEGORIES
------------------------------

## NOTES

1. These Categories are an inclusive list. If you wish to dispose of a waste type **NOT** listed in any of the following categories you must specify this in answer to question 6 on the disposal licence application form (if you are applying for a Waste Disposal Licence) or, if you already hold a Waste Disposal Licence, request in writing to this Authority that the conditions attached to that licence be modified so as to include that waste.
2. Wastes either:
  - a) not specified within these waste categories; or
  - b) from categories for which the site is not licensed; or
  - c)
    - i) Offals subject to Offal Regulations
    - ii) Rhizomania contaminated vegetable or soil waste
    - iii) Explosives
    - iv) Gas cylinders or other pressurised containers

shall not be accepted for disposal in ANY concentration, combination, mixture form or circumstance other than in an emergency in order to avoid danger to the public .

3. Where a waste can be described under two or more of the waste types listed under the following categories, the **HIGHEST** numbered relevant category only shall be taken into account when considering the acceptability of the waste for the purposes of this licence.

WASTE CATEGORY 1 WASTES ARE:

*Permitted*

- Subsoil
- Topsoil
- Clay
- Hardcore
- Brickwork
- Stone
- Concrete
- Sand
- Silica (excluding finely powdered waste (see Category 3 attached))
- Excavated Road Metal
- Glass, Pottery, China, Enamels, Ceramics, Mica and Abrasives

WASTE CATEGORY 2 WASTES ARE:

*Prohibited*

- Household waste (or similar waste from commercial or industrial premises, other than category 3,4 or 5 wastes)
- Vegetable matter
- Animal carcasses or parts thereof
- Animal processing waste
- Animal based glue wastes
- Cellulose waste
- Wood and wood products.
- Paper, Cardboard and fibreboard
- Plastics, as finished products or manufacturing scrap only.
- Plasterboard
- Leather
- Floor sweepings
- Wool, cotton, linen, hemp, sisal, hessian, string, rope, and any other natural or man-made fibre
- Shot blasting residues
- Silicate slag
- Boiler scale
- Carbon, kieselguhr, diatomaceous earth
- Calcium carbonate, calcium sulphate (Gypsum), calcium chloride, magnesium carbonate
- Ash, clinker
- Cement
- Non metallic fragmentiser waste
- Rubber other than tyres
- Tyres only if numbering 5 or less per delivery
- Ferrous metals
- Non hazardous non-ferrous metals

Leachate derived from this facility (but only if disposed of in accordance with a scheme supplied to, and approved by, this Authority as specified in the licence).

**WASTE CATEGORY 3 WASTES ARE:**

Waste specified in a) to h) below which is not "Special Waste" within the meaning of the Control of Pollution (Special Waste) Regulations 1980 (S.I 1980 1709). **PROVIDED THAT THE WASTE HAS A pH OF BETWEEN 4.0 AND 11 WHEN DEPOSITED.**

- a) **Inorganic acids:** Hydrochloric Acid, Sulphuric acid, Nitric acid, Phosphoric acid
- b) **Organic acids and related compounds:**  
 Aliphatic acids e.g. formic acid and acetic acid  
 Aromatic acids e.g. benzoic, phthalic acids  
 Acid anhydrides e.g. acetic, phthalic anhydrides  
 Acid chlorides e.g. acetyl, benzoyl chlorides  
 Sulphonic acids
- c) **Alkalis** Hydroxides of sodium, potassium or calcium  
 Oxides of sodium, potassium or calcium  
 Carbonates of sodium or potassium  
 Proprietary alkaline cleaners
- d) **Non-toxic metal compounds:** Iron, Titanium, Chromium - Trivalent
- e) **Non-toxic organic compounds:** e.g. Dyestuff wastes
- f) **Polymeric materials precursors:** Resins and unfinished polymeric materials, Latex, Latex and rubber solutions and suspensions, Synthetic adhesive wastes, ion exchange resins
- g) **Miscellaneous: Industrial waste of the following descriptions:**  
 Dried or denatured paint, varnish or lacquer  
 Paint spray booth sludges  
 Tar, pitch, bitumen, asphalt  
 Tannery sludge  
 Oil interceptor waste  
 Grinding sludge or dust  
 Pulverised fuel ash  
 Finely powdered silica dust  
 Metal turnings, swarf, dusts or powders  
 Lamps and tubes  
 Batteries  
 Transformers with oil cooling systems  
 Electrical capacitors  
 Photocopiers  
 Tyres if numbering greater than 5 per delivery
- h) **Waste containing materials itemised under waste category 4 but which, due the concentration of those materials, is not a 'Special Waste' under the Control of Pollution (Special Waste) Regulations 1980 with the prior written approval of this Authority for each specific deposit.**

**WASTE CATEGORY 4 WASTES ARE:**

Special waste (as defined in the Control of Pollution (Special Waste) Regulations 1980) by virtue of any of the following.

Antimony and antimony compounds  
Arsenic and arsenic compounds  
Barium and barium compounds  
Boron and boron compounds  
Cadmium and cadmium compounds  
Copper compounds  
Chromium (hexavalent) compounds  
Lead and lead compounds  
Mercury and mercury compounds  
Nickel and nickel compounds  
Phosphorous and phosphorous compounds  
Selenium and selenium compounds  
Silver compounds  
Tellurium and tellurium compounds  
Thallium and thallium compounds  
Vanadium and vanadium compounds  
Zinc compounds  
Acids  
Alkalis  
Biocides and phytopharmaceutical substances  
Laboratory chemicals  
Pharmaceutical and veterinary compounds  
Tarry materials from refining and tar residues from distilling  
Heterocyclic organic compounds containing oxygen, nitrogen or sulphur  
Hydrocarbons and their oxygen, nitrogen and sulphur compounds  
Inorganic cyanides  
inorganic halogen containing compounds  
Inorganic sulphur containing compounds  
Organic halogen compounds  
Any medicinal product available only on prescription  
Asbestos cement  
Asbestos fibres

**WASTE CATEGORY 5 WASTES ARE:**

Clinical wastes (with the exception of "household waste"):

Clinical wastes are defined in the "Collection and Disposal of Waste Regulations 1988" as follows:

- (a) any waste which consists wholly or partly of human or animal tissue, blood or other body fluids, excretions, drugs or other pharmaceutical products, swabs or dressings, or syringes, needles or other sharp instruments, being waste which unless rendered safe may prove hazardous to any person coming into contact with it; and
- (b) any other waste arising from medical, nursing, dental, veterinary, pharmaceutical, or similar practice, investigation, treatment, care, teaching or research, or the collection of blood for transfusion, being waste which may cause infection to any person coming into contact with it.

**ONLY** the following types of clinical wastes may be accepted for disposal at landfill sites:

- (i) Soiled animal bedding;
- (ii) Soiled nappies, incontinence pads and other faeces/urine contaminated materials.
- (iii) Clinical waste which has been "made safe" by autoclaving in an autoclave which conforms with the requirements of the Pressure Systems and Transportable Gas Containers Regulations 1989.
- (iv) Bulky, or large, items which are impractical to dispose of via incineration may be considered for landfill with the prior approval of this Authority.

**ANY MATERIALS FROM QUARANTINE PREMISES OR RESEARCH ESTABLISHMENTS WHICH MAY BE DEALING WITH POTENTIALLY INFECTIOUS DISEASES, OR FROM PATIENTS WITH A NOTIFIABLE DISEASE, MUST BE INCINERATED.**

1

W. 11.7  
172.84  
172.84

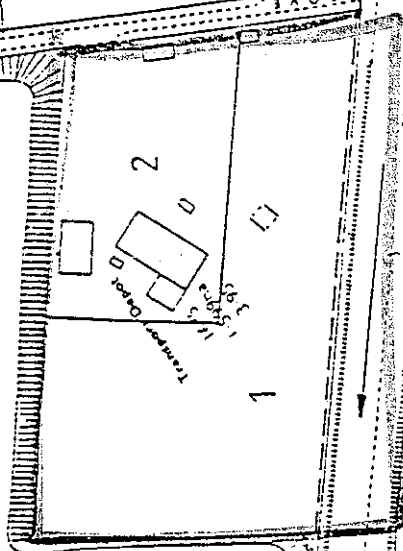
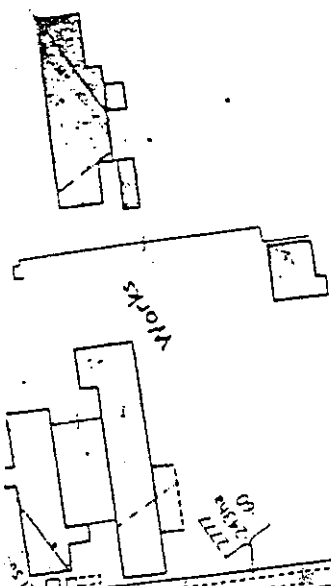

SECOND

151  
151

153 21074 52

*Handwritten signature*

SITE LICENSE, ON  
BEHALF OF MICK  
GEORGE (HAULAGE) LTD

Andrew S. Campbell Associates  
Planning and Development Consultants

Stable Court, Ferrars Road,  
Huntingdon,  
Cambs. PE18 6DH.  
Telephone (0480) 52044

Scale	1:2500	Date	FEB 94
Drawn		Checked	
Drawing No.		ASC/92/9/S1	